

ARNOLD

Güterzug-Ellok
Krokodil CE 6/8"

2465, 2467,
2468, 2475,
2478, 2479

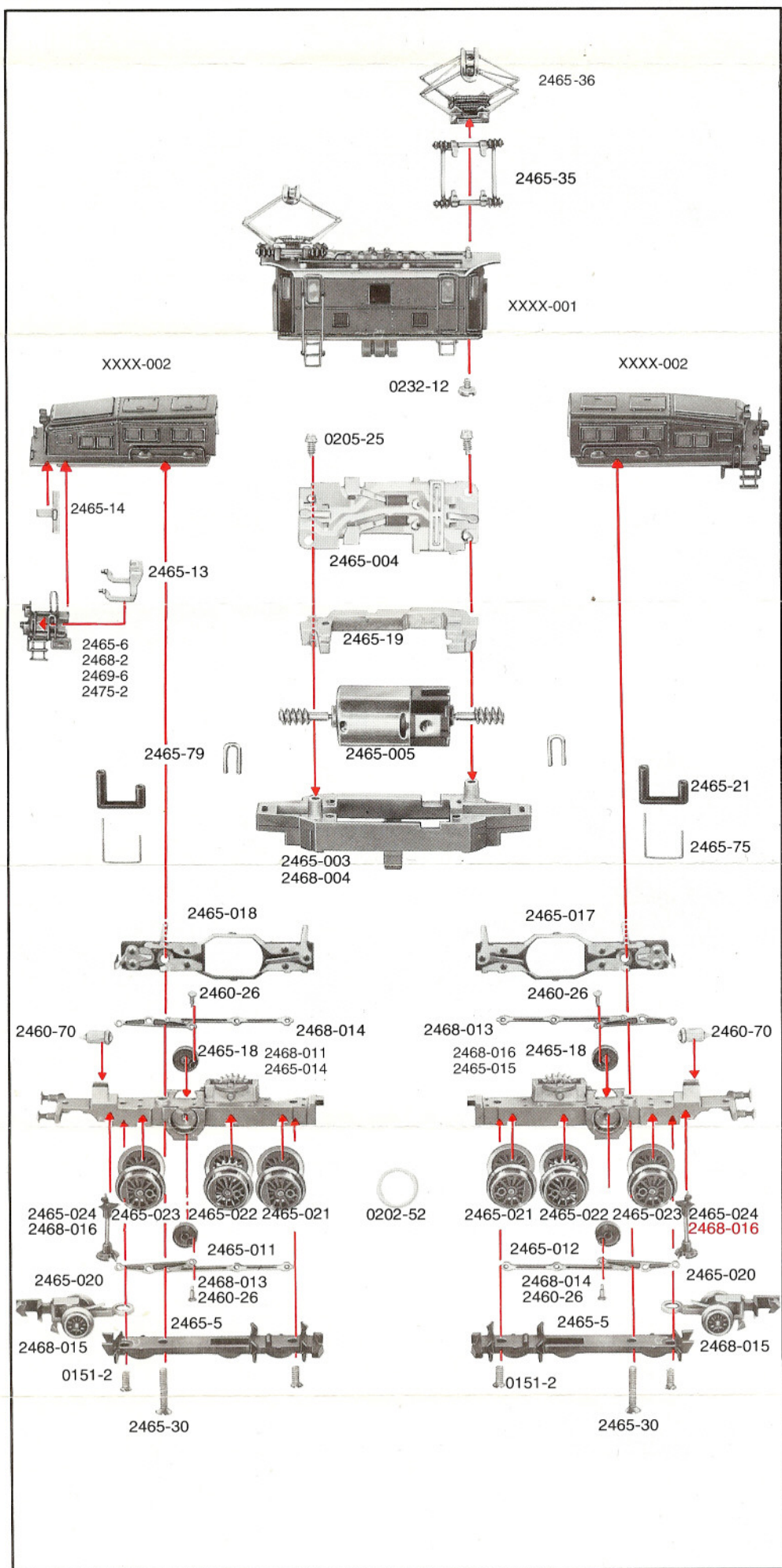
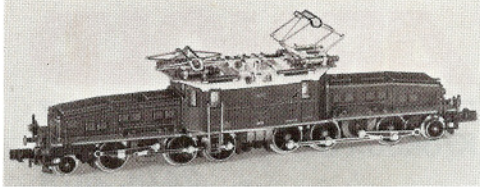

ARNOLD

Güterzug-Ellok
Krokodil CE 6/8"

2465, 2467,
2468, 2475,
2478, 2479

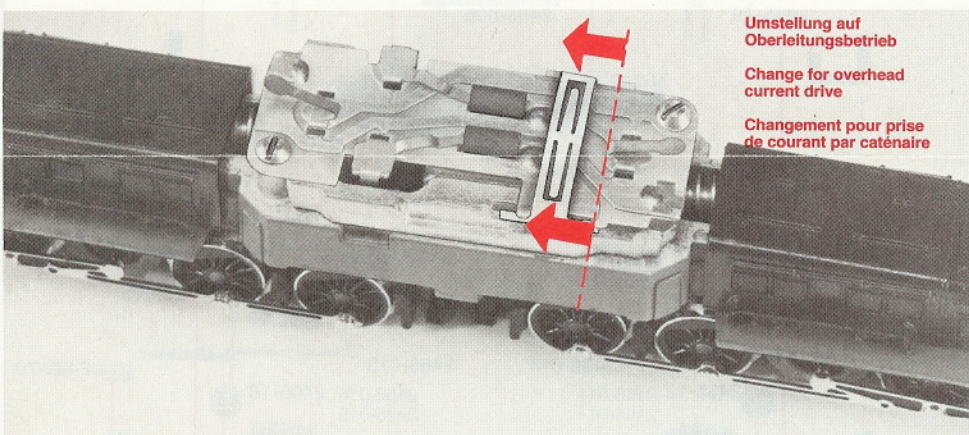
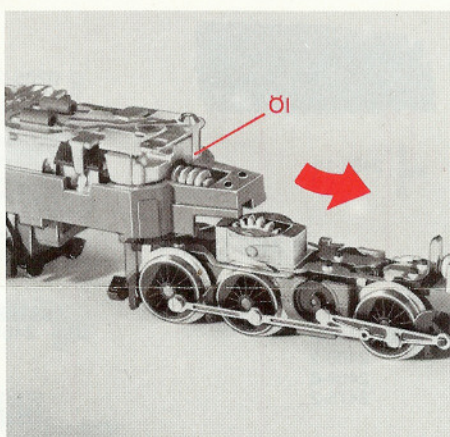
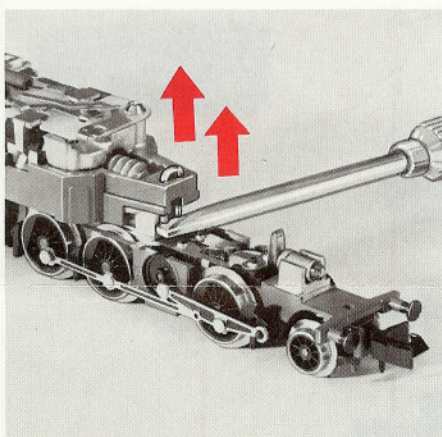
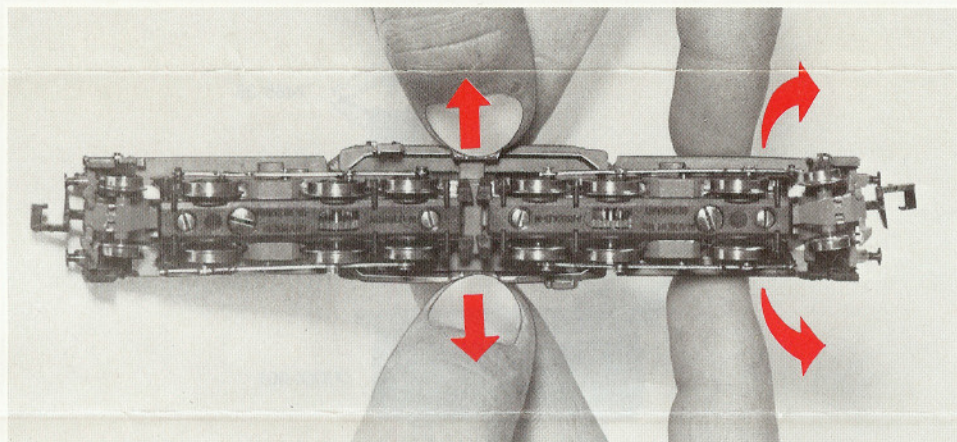
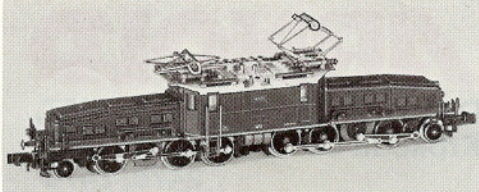

Umstellung auf
Oberleitungsbetrieb

Change for overhead
current drive

Changement pour prise
de courant par caténaire

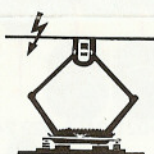
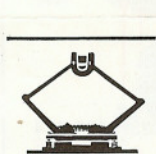

Kohlewechsel
Replacing carbon brushes
Changement des balais

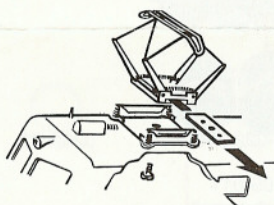

Haftreifenwechsel
Changing traction tires
Echange des bandages anti-dérapants

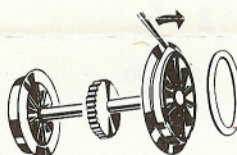
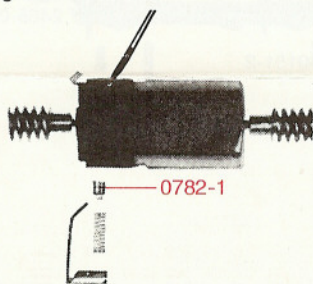

0202-52